

Property Location:

160 Gladhill Acres

Residential Property Record Card - Hoke County, North Carolina

PIN No. 594060001010

Account No: 238116

Class: 03

Occupancy: 37

Card 1 of 1

Current Owner
Couture, Daniel Adam 160 Gladhill Acres Raeford Nc 28376

Previous Owner History			
Name	Deed	Date	
Mcdonald, Donnalee Gladhill	/	12/09/2015	
Gladhill, Frank H Jr	216/807	01/01/1981	
Gladhill, Frank H Jr	216/807	01/01/1981	

Miscellaneous	
Deed Info:	1174/914-11/22/2016-
Zoning:	
Property No:	0005529
Neighborhood:	22
Living Units:	0
Census Trct:	
District:	5
Estimates	
MRA:	
Weighted:	
Market:	

Assessment Information		
Appraised Value:	*	Prior
Land:	271,140	171,260
Building:	218,850	286,840
Total:	489,990	458,100
Assessed Information:		
	Value:	489,990
Effective DOV: 1/1/2022		
Value Flag: COST VALUE		
Manual Override Reason:		

Notes
Map 222 Lot 3 Removed 1 Chicken House Burned For 2011 Adj Value Chicken Hse For 2015

Entrance Information					
Date	Time	ID	Actv	Entrance Code	Source
02/02/2021		GB		Ownr Not Hom	Estimate
11/29/2021		BP		Ownr Not Hom	Estimate
12/13/2021		SB		Ownr Not Hom	Estimate

Sales History				
Book/Page	Date	Price	Type	Validity
1174/914	11/22/2016	557,000	2	0
1158/622	07/12/2016		2	E

Permit Information				
Date	Permit #	Price	Purpose	% Comp.
				0
				0

Land Information				
Type	Size	Grade	Influence Factor 1, 2 and %	Value
Bldg Site	A	2 0	0	45,000
Open Land	A	19 0	0	48,450
Wooded	A	112.028 0	0	142,840
Undeveloped	A	5 0	0	34,850
Total Acres for this Parcel		138.028	Total Land Value	271,140

Out Building Information								
Type	Qty	Year	Size1	Size2	Grade	Cond	%Good	Value
Poultry Broiler House	1	1990	41	500	C	A	26%	61,290
Mobile Home-Sing Wide	1	0	1	0	C	A	15%	0
Well House	1	0	1	0	C	A	0%	2,000
Septic Tank	1	0	1	0	C	A	0%	3,000
	0	0	0	0			0%	0
	0	0	0	0			0%	0
	0	0	0	0			0%	0
Total OBY for this card								66,290

No Picture Available

Inspection witness by: _____



(7.5.66.16)

Printed Tue, Oct 8, 2024

Property Location:

Residential Property Record Card - Hoke County, North Carolina

160 Gladhill Acres

PIN No. 594060001010

Account No: 238116

Class: 03 Occupancy: 37 Card 1 of 1

Dwelling Information	
Style:	Ranch
Condo Style:	
Exterior Walls:	Frame
Story Height:	1.0
Attic:	Part Finsh
Interior/Exterior:	
Basement:	Crawl
Bsmt Garage:	0
Rec Room size:	0 0
FBLA size:	0 0
Unfinished Area:	0
Inlaw Apts:	0
WB Fireplace:	Stacks 1 Openings 1
MTL Fireplace:	Stacks 0 Openings 0
Heating Type:	Htac
Fuel:	Electric
Heating System:	Heat Pump
Year Built:	1988
Eff. Yr Built:	1992
GFA/True GFA:	1770 1770
TLA/True TLA:	2212 2212
Basement Area:	0
Grade:	
Condition:	
CDU:	GD
Building Notes:	

	Low	1st	2nd	3rd	Tot
Rooms:	0	0	0	0	0
Bedrooms:	0	0	0	0	0
Full Baths:	0	0	0	0	2
Half Baths:	0	0	0	0	0
Add'l Fixtures:	0	0	0	0	0

Replacement Costs	
Base Price:	134,080
Additions:	25,000
Unfinished Area:	0
Basement:	0
Attic:	19,220
Plumbing:	3,000
Heating A/C Adj.:	7,330
FBLA:	0
Rec Room:	0
Fire Place:	4,000
Basement Garage:	0
Exterior Trim:	0
Subtotal:	192,630
Grade Factor:	1.10
C & D Factor:	0.00
Total RCN:	211,890
Percent Good:	0.72
Market Adj.:	0.00
Total RCNLD:	152,560

Addition Information					
Low	1st	2nd	3rd	Area	Points
				126	3700
				462	13600
				200	7700

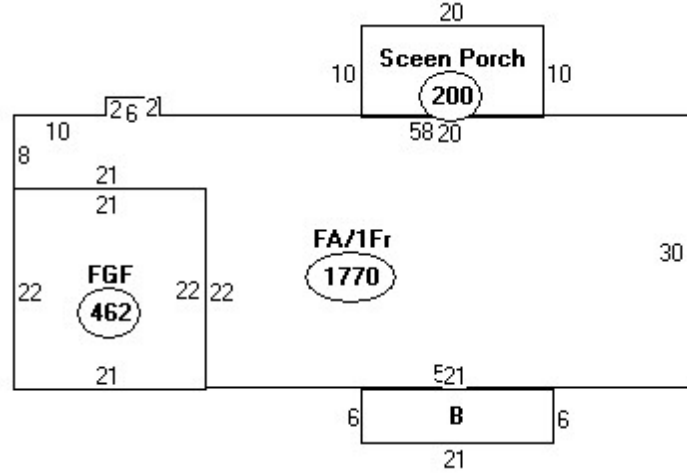

- Descriptor/Area
- A: FA/1Fr
1770 sqft
 - B: CvP
126 sqft
 - C: FGF
462 sqft
 - D: Screen Porch
200 sqft

Owner/Values: Includes all Land/Buildings/OBYs for this Parcel					
	Current	Cost	Market	Income	Prior
Land:	271,140	271,140	0	0	171,260
Building:	218,850	218,850	0	0	286,840
Total:	489,990	489,990	0	0	458,100

Comparable Sales Summary							Year	Bed-	Bath		Acres
Parcel ID	Location	DOS	Price	TLA	Style	Grade	built	room	Full	Half	
				0			0	0	0	0	0
				0			0	0	0	0	0
				0			0	0	0	0	0
				0			0	0	0	0	0
				0			0	0	0	0	0